

- ISDN U<sub>KO</sub>-INTERFACE TRANSFORMER:

**ELECTRICAL SPECIFICATION @25°C**

| UMEC PART NO.       | Turns Ratio (Line:Chip (±2%)) | Line Side Pins | Line Side Inductance (mH) | DC BIAS (mA max) | Leakage Inductance (uH) | Coupling capacitance (pF) | DCR Line Side (Ω) | DCR Chip Side (Ω) | Isolation VAC | Package & Schematic |
|---------------------|-------------------------------|----------------|---------------------------|------------------|-------------------------|---------------------------|-------------------|-------------------|---------------|---------------------|
| UT20583             | 1.5:1                         | (4-2)          | 28.0 ± 5%                 | 60               |                         |                           | 20.0 max          | 3.0 max.          | 2000          | POT 23*11/C         |
| UT20628             | 1.25:1                        | (1-5)          | 28.0 ± 5%                 | 80               |                         |                           | 12.0 max          | 7.0 max.          | 2000          | POT 23*11/C         |
| UT20628A            | 1.25:1                        | (1-5)          | 28.0 ± 5%                 | 80               |                         |                           | 12.0 max          | 9.0 max.          | 2000          | POT 23*18/B         |
| UT20631             | 1.5:1                         | (4-2)          | 27.0 ± 5%                 | 60               |                         |                           | 20.0 max          | 3.0 max.          | 2500          | POT 23*11/C         |
| UT21001             | 1.25:1                        | (8-6)          | 27.0 ± 8%                 | 90               | 150 max.                | 150 max.                  | 6.0 nom.          | 3.9 nom.          | 2000          | RM8/F               |
| UT21901             | 1.6:1                         | (2-5)          | 14.5 ±10%                 | 50               | 71 max.                 | 150 max.                  | 5.6 ±15%          | 4.1 ±15%          | 500           | RM6/H               |
| UT21902             | 1.32:1                        | (2-5)          | 5.5 ±10%                  | 50               | 22 max.                 | 125 max.                  | 3.3 ±15%          | 2.85 ±15%         | 500           | RM6/H               |
| UT21903             | 1.25:1                        | (1-4)          | 28.0 ± 5%                 | 50               | 120 max.                | 80 max.                   | 12.0 max          | 9.0 max.          | 2000          | RM6/G               |
| UT21904             | 1.32:1                        | (5-8)          | 7.6 ± 8%                  | 55               | 50 max.                 | 75 max.                   | 2.4 max.          | 2.7 max.          | 2000          | RM6/G               |
| UT21905             | 1.25:1                        | (1-11)         | 28.0 ± 5%                 | 80               | 60 max.                 |                           | 10.0 max          | 5.0 max.          | 2000          | RM8/F               |
| UT21906             | 1.6:1                         | (1-4)          | 13.3 ±10%                 | 60               | 45 max.                 | 70 max.                   | 5.0 max.          | 5.0 max.          | 2000          | RM6/G               |
| UT21907             | 1.32:1                        | (1-4)          | 7.7 ±10%                  | 60               | 40 max.                 | 45 max.                   | 3.8 max.          | 3.8 max.          | 2000          | RM6/G               |
| UT21910             | 1.6:1                         | (8-11)         | 14.5 ±10%                 | 60               | 90 max.                 | 100 max.                  | 2.7 max.          | 2.8 max.          | 2500          | RM8/E               |
| UT21911             | 1.5:1                         | (1-4)          | 27.0 ±10%                 | 40               | 150 max.                | 150 max.                  | 14.8 max          | 11.1 max          | 2500          | RM6/G               |
| UT21913             | 1.5:1                         | (1-4)          | 27.0 ± 5%                 | 60               |                         |                           | 20.0 max.         | 3.0 max.          | 2000          | RM6/G               |
| UT21917             | 1.5:1                         | (2-5)          | 27.0 ±10%                 | 90               | 150 max.                | 350 max.                  | 18.0 max.         | 7.5 max.          | 3750          | RM8/E               |
| UT21921             | 1.5:1                         | (9-7)          | 81.5 ± 5%                 | 30               | 100-172                 |                           | 10.3 nom.         | 21.3nom.          | 1500          | POT 23*11/C         |
| UT21921A            | 1.5:1                         | (9-7)          | 81.5 ± 5%                 | 30               | 100-172                 |                           | 6.81 ±15%         | 12.3±15%          | 1500          | POT 23*18/B         |
| UT21924             | 1.5:1                         | (2-12)         | 80.0 ±10%                 | 80               | 160 max.                |                           | 13.8 max.         | 11.8max.          | 2000          | RM8/F               |
| UT21928             | 1.5:1                         | (1-5)          | 81.5 ± 5%                 | 30               | 180 max.                | 250 max.                  | 12.3 15.2         | 9.2-11.3          | 4000          | EP20/D              |
| UT21942             | 1.32:1                        | (8-6)          | 14.5 ±10%                 | 60               | 55 max.                 | 60 max.                   | 1.8 nom.          | 2.8 nom.          | 2000          | RM8/F               |
| UT21945             | 1.32:1                        | (8-6)          | 7.9 ±10%                  | 60               | 50 max.                 | 75 max.                   | 1.3 nom.          | 1.9 nom.          | 2000          | RM8/F               |
| UT21954             | 1.6:1                         | (8-6)          | 14.5 ±10%                 | 60               | 90 max.                 | 100 max.                  | 2.7 nom.          | 2.8 nom.          | 2000          | RM8/F               |
| UT21958             | 1.6:1                         | (8-6)          | 14.5 ±10%                 | 60               | 100 max.                | 90 max.                   | 2.7 nom.          | 2.8 nom.          | 2500          | RM8/F               |
| UT21959             | 1.5:1                         | (8-6)          | 27.0 ±10%                 | 90               | 150 max.                | 150 max.                  | 6.0 nom.          | 3.9 nom.          | 2000          | RM8/F               |
| UT21960             | 2:1                           | (1-11)         | 27.0 ± 5%                 | 80               | 150 max.                | 180 max.                  | 6.2 nom.          | 2.7 nom.          | 2000          | RM8/F               |
| UT21961             | 2.5:1                         | (8-6)          | 14.5 ±10%                 | 60               | 100 max.                | 100 max.                  | 2.7 nom.          | 1.8 nom.          | 2000          | RM8/F               |
| UT21963             | 1.6:1                         | (1-4)          | 13.3 ±10%                 | 60               | 70 max.                 | 90 max.                   | 4.9 nom.          | 4.8 nom.          | 2000          | RM6/G               |
| UT21972             | 1.32:1                        | (1-4)          | 6.9 ±10%                  | 60               | 70 max.                 | 65 max.                   | 4.5 nom.          | 3.4 nom.          | 2000          | RM6/G               |
| UT20575/<br>UT35473 | 1.65:1                        | (1-4)          | 15.5 ±16%                 | 50               | 75 max.                 |                           | 5.0 max.          | 3.0 max.          | 2000          | POT 18*11/A         |

Inductance : the inductance of windings on line side in series ( at 10KHz 100mV ).

Coupling capacitance : the coupling capacitance between of windings on line side and the windings on chip side ( at 10KHz 100mV ).

Leakage inductance : the leakage inductance of windings on line side with windings on chip side shorted ( at 100KHz 100mV ).



• ISDN U<sub>KO</sub>-INTERFACE TRANSFORMER:

A POT 18\*11

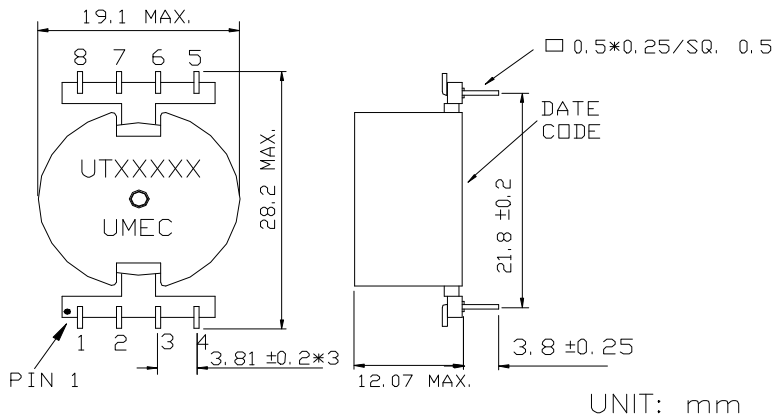

B POT 23\*18

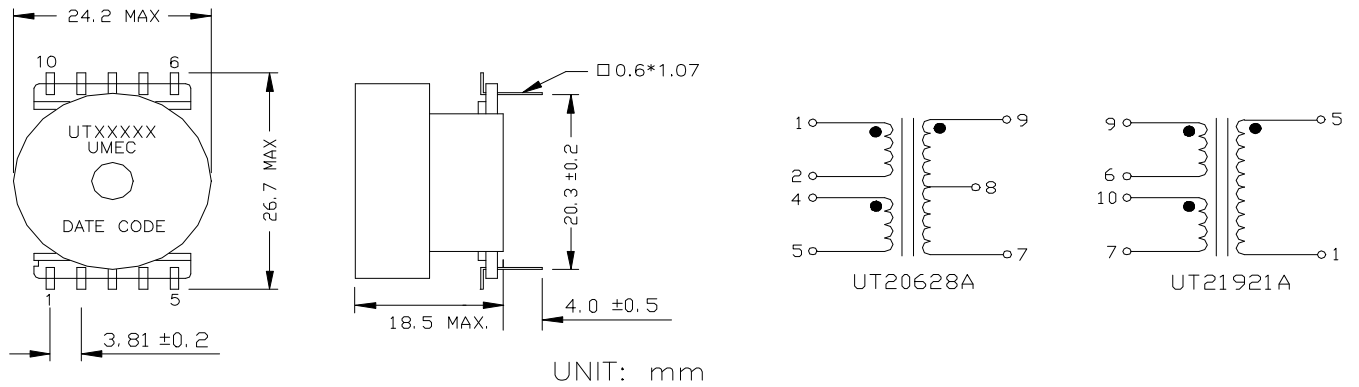

C POT 23\*11

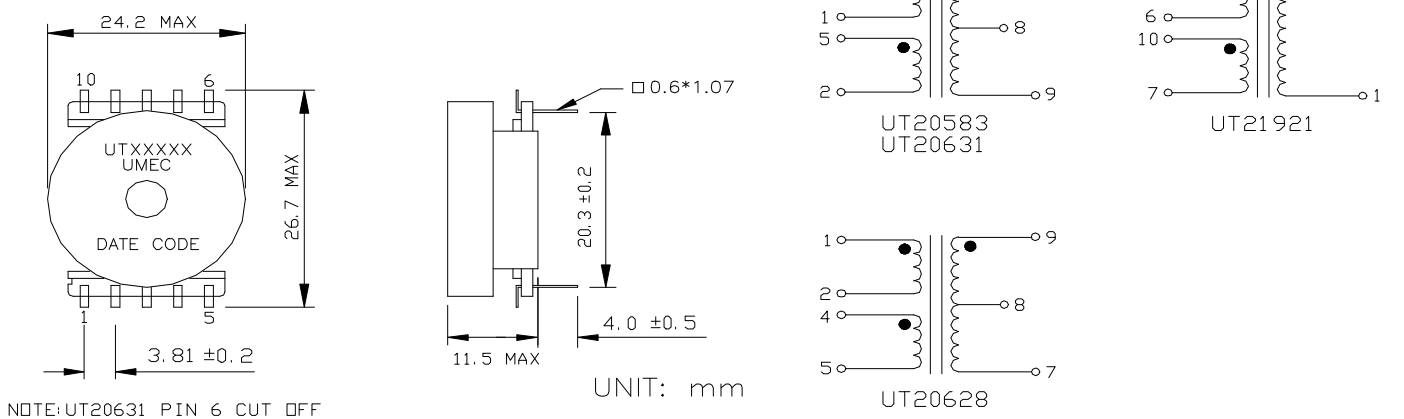

D

EP20

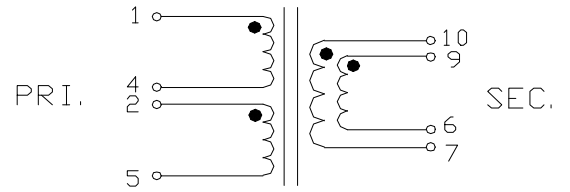
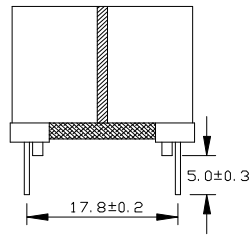
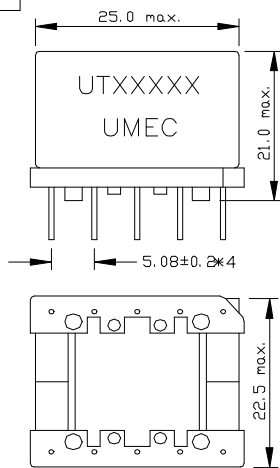

UNIT: mm

E

RM8 DUAL

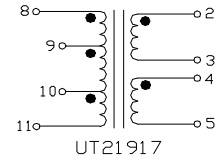
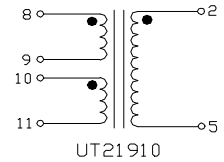
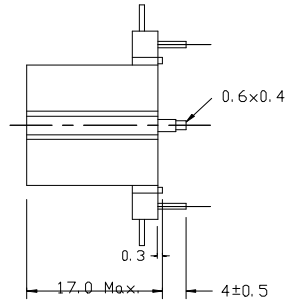
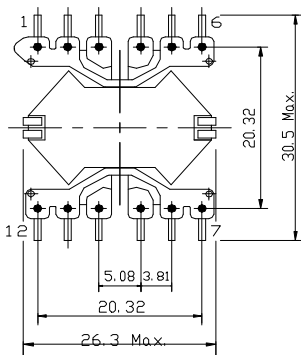

UNIT: mm

F

RM8

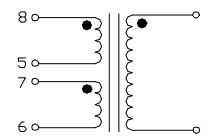
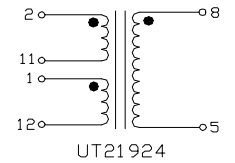
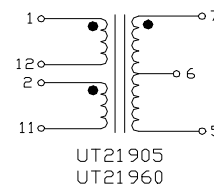
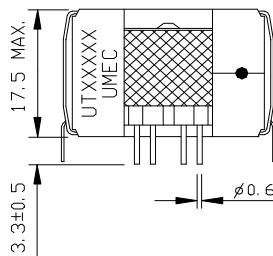
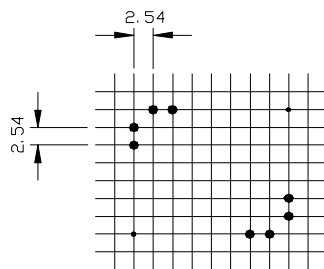
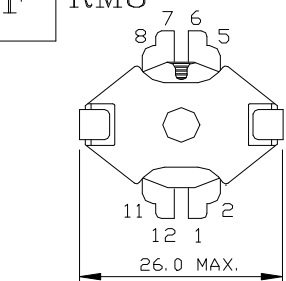

UNIT: mm



G

RM6 DUAL

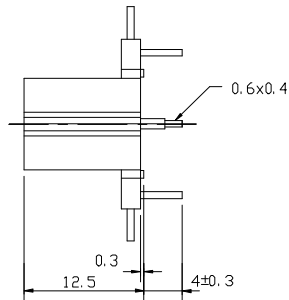
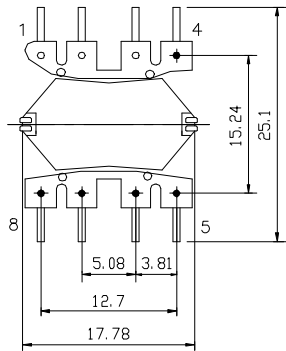

UNIT: mm

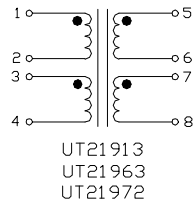
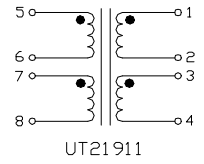
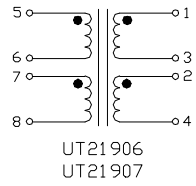
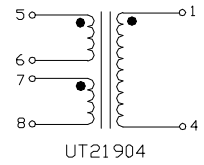
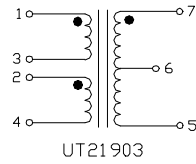

H

RM6

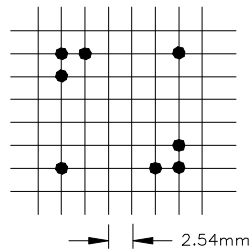
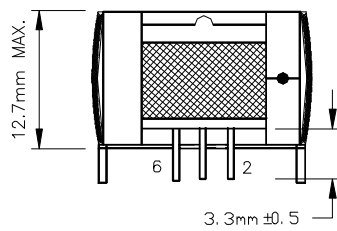
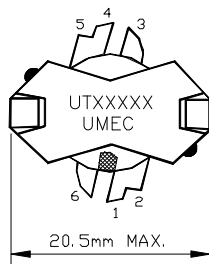

UNIT: mm

